

Typical Roof Section
1:5

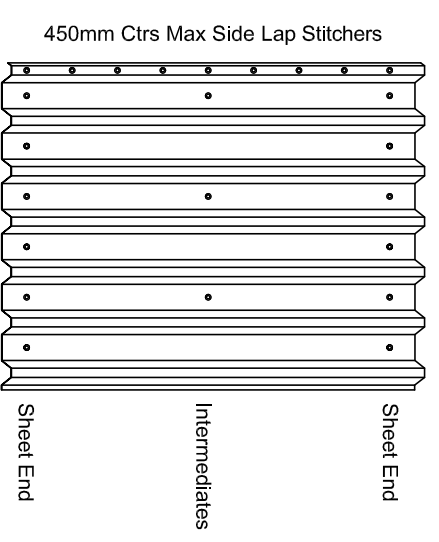

Top Sheet Fixing Arrangement
N/S

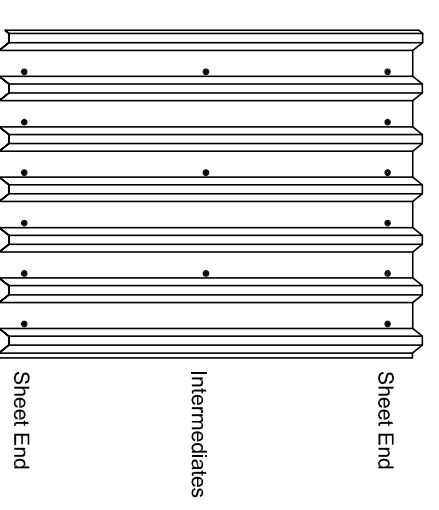

Liner Sheet Fixing Arrangement
N/S

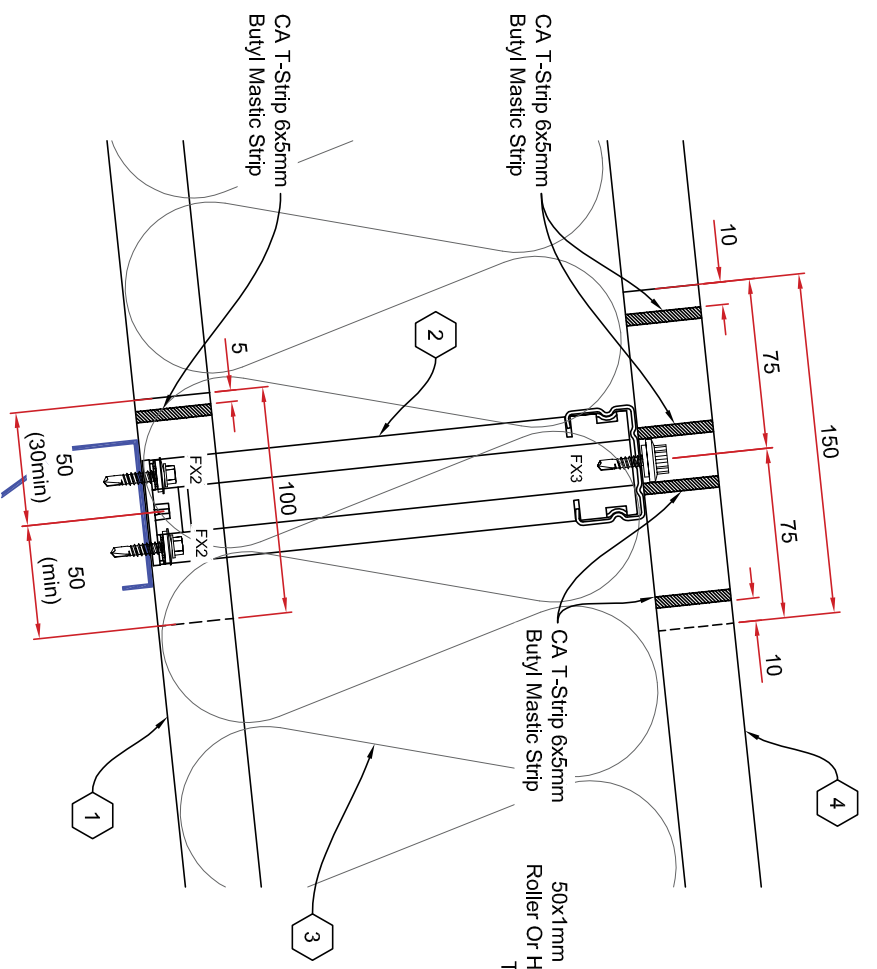

Typical Roof Section
1:3.33

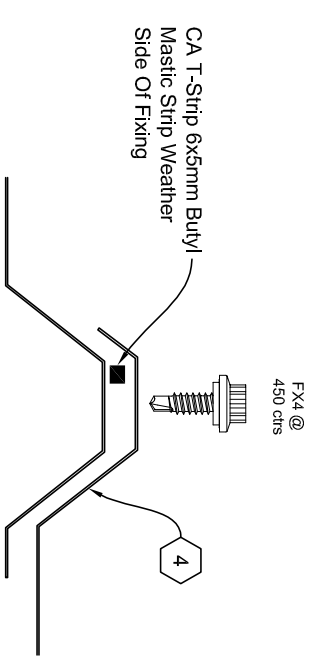

Top Sheet Side Lap Detail
1:2.5

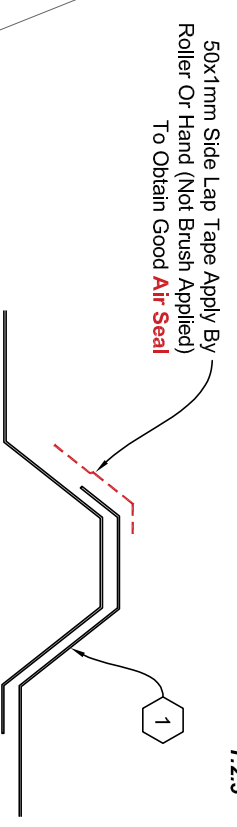

Liner Sheet Side Lap Detail
1:2.5

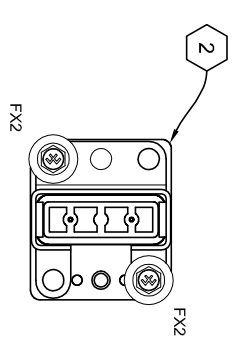

Matrix Bracket Fixing Locations
1:2.5

Notes

- A) To Be Read In Conjunction With SP01 For All Fixing Codes
- 1) 0.7mm Bright White CA 32/1000RL Liner Panel
- 2) CA MX220 Matrix Spacer Bracket & Rail System
- 3) TQ 220mm CA Thermo-quit Insulation 0.040 Lambda Value - All Tucked & Lapped Tight - **No Gaps**
- 4) 0.7mm CA 32/1000R Top Sheet, Colour: **TBC** HPS200 Ultra

Specification Shown Achieves
U-Value Rating Of 0.20W/m²K
25 Years Guarantee

APPROVAL

No.	REVISION	DATE	BY
AP1	First Issue	28-02-17	GR

Drawing Title: **Built Up Roof System Specification**

Drawn By: **GR** Date: Feb 2017
 Contract: **Varies @ A3** J392-SF05 Rev: AP1