

Notes

- A) To Be Read In Conjunction With SP01 For All Fixing Codes
 - B) To Be Read In Conjunction With SP05 For Roof Specification
 - C) To Be Read In Conjunction With SP08 For Parapet Cladding Spec
- 1) 0.7mm Bright White CA 32/1000RL Liner Panel
 - 2) CA WX220 Matrix Spacer Bracket & Rail System
 - 3) TQ 220mm CA Therna-quilt Insulation 0.040 Lambda Value - All Tucked & Lapped Tight - **No** Gaps
 - 4) 0.7mm CA 32/1000R Top Sheet, Colour: **TBC** HPS200 Ultra
 - 10) 40mm Kingspan RW Composite Parapet Wall Panel, Colour: **TBC** XL Forte
 - 11) 1.2mm Membrane Coated Steel Gutter c/w 50mm PIR Insulation Board c/w 0.7mm Bright White Liner, Item Ref: **G1**
 - 12) 0.7mm HPS200 Ultra Roof Closure Flashing - 100mm buttstrap, Colour: **TBC**, Item Ref: **F4**
 - 13) 0.7mm HPS200 Ultra Roof Closure Flashing - 100mm buttstrap, Colour: **TBC**, Item Ref: **F4**

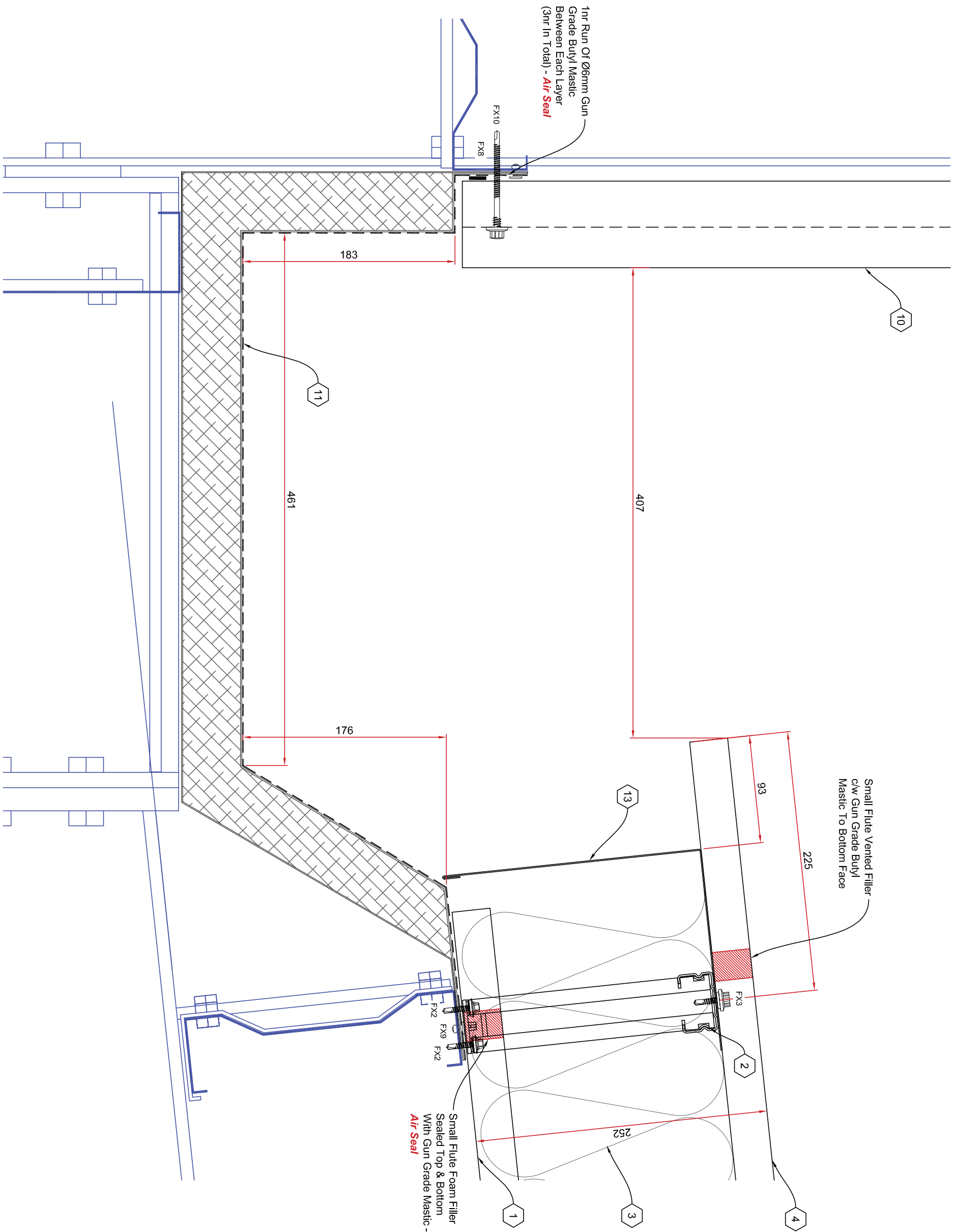

Drawing Title: **Gutter Detail To GL 1 & 5**

Contract: _____

No.	REVISION	DATE	BY
AP1	First Issue	28-02-17	GM

APPROVAL

Drawn By: GM	Date: Feb 2017
Scale: 1:3.33 @ A3	Drawing No.: J392-DT01
	Rev: AP1